

I-MACH

Compact. Flexible. Efficient.



兩板注塑機系列

TWO PLATEN HYDRAULIC PLASTIC INJECTION MOULDING MACHINE SERIES
Clamping Force 35-350T



仁興機器廠有限公司 (總部)
Yan Hing Engineering Works Ltd.
香港九龍觀塘開源道 62 號駱駝漆大廈第 2 座 5 字樓 A&B 室
Flat A&B, 5/F., Block 2, Camelpaint Buildings,
62 Hoi Yuen Road, Kwun Tong, Kowloon, Hong Kong.
電話 Tel: (852) 2389 1338 傳真 Fax: (852) 2797 8661
郵箱 E-mail: info@yanhing.com

仁興機械 (佛山) 有限公司 (工廠)
Yan Hing Machinery (Foshan) Co., Ltd.
中國廣東省佛山市高明區楊和鎮高明大道中人景路 13 號
13 Renjing Rd., Yanghe Town, Gaoming District, Foshan City, P.R. China.
電話 (Tel): 0757-8880 3372 傳真 (Fax): 0757-8880 3329

www.yanhing.com
www.prowin.com.hk



YH20180419.1

I-MACH

Compact Efficient Flexible

Clamping Force 35-350T

I-MACH Series offers clean, flexible, cost saving solution for variety of applications. For a compact and space efficient solution, IMACH offers hydraulic two platen clamping. To ensure precision for users, IMACH is equipped with ST series single cylinder injection system.

I-MACH 系列提供乾淨、靈活、節約營運成本的優質方案，適應廣泛的應用。二板設計提供更有效的空間效率、更平均的鎖模結構。I-MACH 同時具備 ST 單缸射臺系統，確保高射膠精密度。

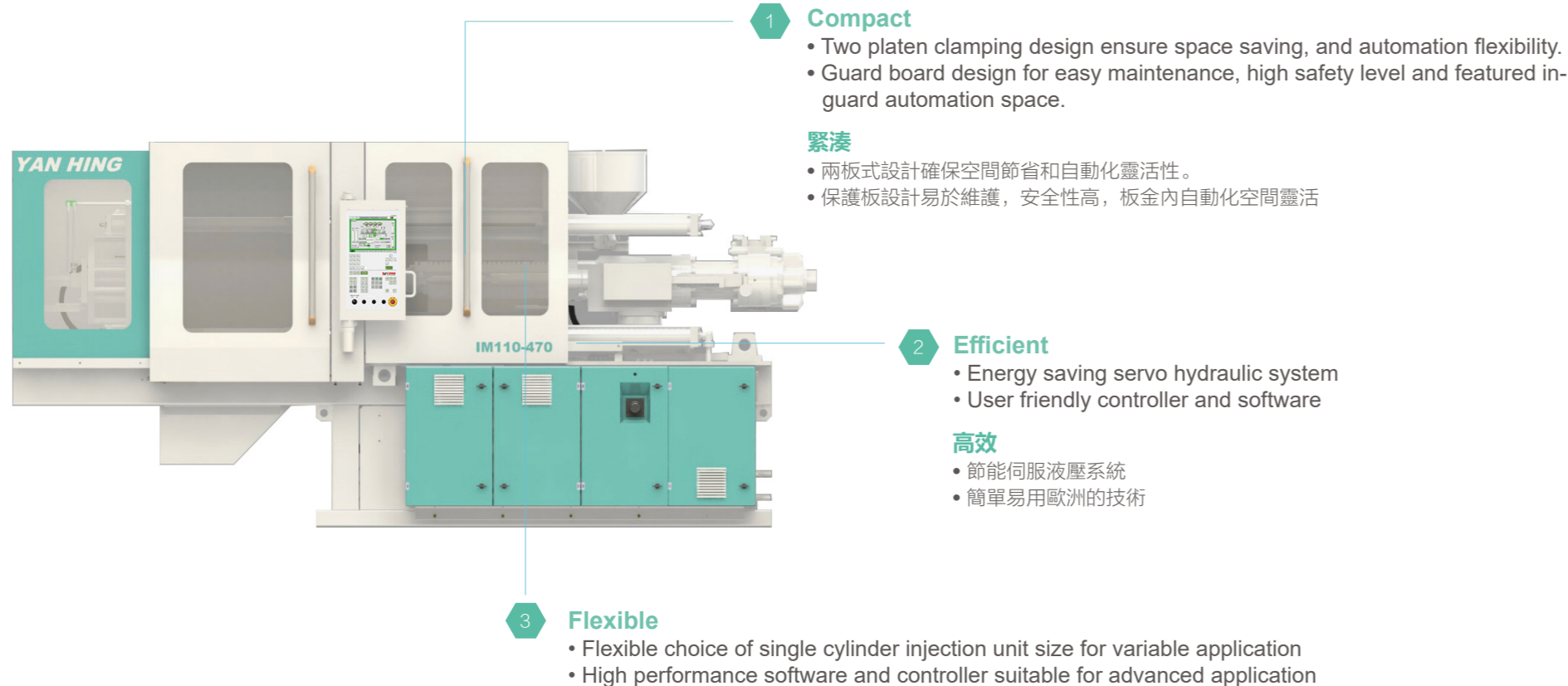

1 Compact

- Two platen clamping design ensure space saving, and automation flexibility.
- Guard board design for easy maintenance, high safety level and featured in-guard automation space.

緊湊

- 兩板式設計確保空間節省和自動化靈活性。
- 保護板設計易於維護，安全性高，板金內自動化空間靈活

2 Efficient

- Energy saving servo hydraulic system
- User friendly controller and software

高效

- 節能伺服液壓系統
- 簡單易用歐洲的技術

3 Flexible

- Flexible choice of single cylinder injection unit size for variable application
- High performance software and controller suitable for advanced application

靈活

- 靈活選擇單缸注射單元尺寸以適應不同的應用
- 高性能軟件和控制器適用於高級應用

I-MACH 35

| 項目 | Items | Unit | I-MACH 35 | | |
|-----------------|---|---------|-------------------------------|----------------|----------------|
| | | | ST125 | ST180 | ST245 |
| 鎖模力 | Mould Locking Force | kN | 350 | | |
| 開模力 (高壓) | Mould Unlocking Force | kN | 44.3 | | |
| 移模力 (鎖模) | Mould Close Force | kN | 26.3 | | |
| 移模力 (開模) | Mould Open Traverse Force | kN | 18 | | |
| 最大鎖模行程 | Max. Mould Open Stroke | mm | 350 | | |
| 最小容模厚度 | Min. Mould Height | mm | 175 | | |
| 最大容模厚度 | Max. Mould Height | mm | N/A | | |
| 模板最大開距 | Max. Daylight | mm | 525 | | |
| 四柱內距 (水平 x 垂直) | Space Between Tie-bars (HxV) | mm | 320 x 320 | | |
| 模板尺寸 | Platen Size (HxV) | mm | 500 x 500 | | |
| 哥林柱直徑 | Diameter of Tie-bars | mm | 45 | | |
| 頂針力 | Ejector Force, Forward/Retract | kN | 34.6/23.7 | | |
| 最大頂針行程 | Max. Ejector Stroke | mm | 80 | | |
| 最大移模速度, 開模 / 鎖模 | Max. Velocity (Open/Close) | mm/sec | 816/557 | | |
| 最大模具重量 | Max. Mould Weight - Total/Moving platen | kg | 500/300 | | |
| 射台型號 | Injection Unit | | ST125 | ST180 | ST245 |
| 螺桿直徑 | Screw Diameter | mm | 23 25 28 25 28 32 | 28 32 28 32 36 | |
| 理論注射容積 | Swept Volume | c.c | 41 54 67 61 77 101 | 86 112 142 | |
| 注射重量 (PS) | Shot Weight (PS) | g | 43 51 64 55 70 91 | 78 102 129 | |
| 注射壓力 | Specific Injection Pressure | bar | 2679 2268 1808 3087 2460 1884 | 2952 2260 1785 | |
| 高注射率 | Injection Rate | c.c/sec | 66 77 96 56 71 92 | 59 77 98 | |
| 注射速度 | Injection Velocity | mm/sec | 157 115 96 | | |
| 塑化能力 (PS) | Plasticizing Capacity (PS) | g/sec | 7.9 9.7 12.8 9.7 12.8 18.6 | 9.9 14.4 20.4 | |
| 螺桿長徑比 | Screw L:D Ratio | L/D | 23 20 17.8 22.4 20 17.8 | 22.8 20 17.8 | |
| 注射行程 | Screw Stroke | mm | 115 125 140 | | |
| 螺桿轉距 | Screw Torque | Nm | 320 403 503 | | |
| 螺桿轉速 | Screw Speed | r.p.m. | 10-518 | 10-356 | 10-285 |
| 射咀接觸力 | Nozzle Sealing Force | kN | 37.71 37.71 37.71 | | |
| 射咀行程 | Nozzle Retract Stroke | mm | 220 220 220 | | |
| 電熱功率 | Heating Capacity of Barrel | kW | 4 4.5 5.5 | | |
| 加熱區的數量 | Number of Heating Zones & Barrel | qty | 3 + N 4 + N 4 + N | | |
| 油泵電機功率 | Rated Power of Pump Drive Servo Motor | kW | 11 | | |
| 油箱容積 | Oil Filling | l | 150 | | |
| 液壓系統壓力 | Hydraulic System Pressure | bar | 175 | | |
| 機器重量 | Machine Weight, Dry | Tons | 1.7 1.8 1.8 | | |
| 外形尺寸 (LxWxH) | Machine Dimensions (LxWxH) | m | 3.04x1.16x1.89 | 3.14x1.16x1.89 | 3.24x1.16x1.89 |
| 幹循環時間 | Dry Cycle Time (EUROMAP 6) | mm-sec | 245-1.4 | | |
| 國際尺寸評級 | International Size Rating (EUROMAP) | ref | 350H-128 350H-189 350H-254 | | |

• 最小模具尺寸 (mm) 為 220x220 / Smallest tolerable mould dimension: 220x220 (mm)
 • 本公司可以隨時修改以上技術參數而無須預先通知 / The above specifications can be altered without prior notice

Machine Specification 機器參數

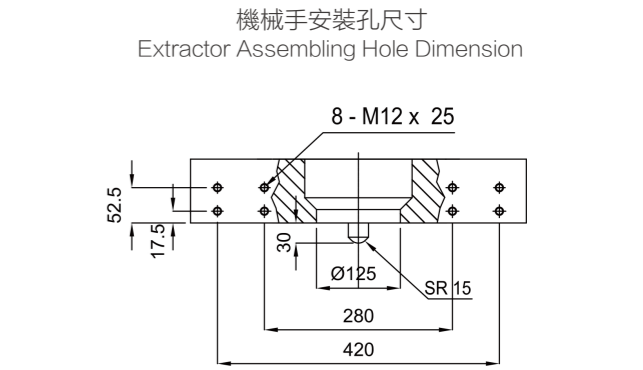
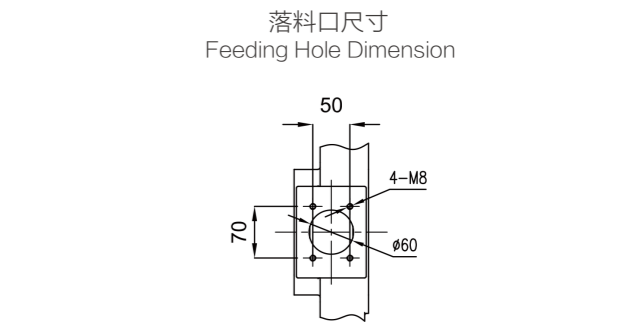
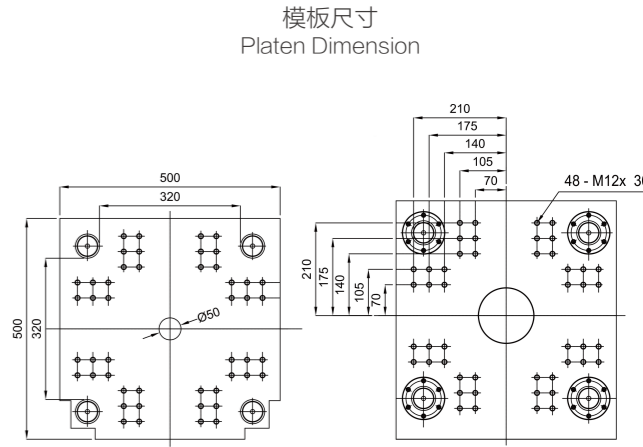

I-MACH 50

Machine Specification 機器參數

| 項目 | Items | Unit | I-MACH 50 | | | | | | | | | |
|-----------------|---|---------|---------------|------|------|---------------|------|------|---------------|------|------|--|
| | | | ST180 | | | ST245 | | | ST330 | | | |
| 鎖模力 | Mould Locking Force | kN | 500 | | | | | | | | | |
| 開模力 (高壓) | Mould Unlocking Force | kN | 56.1 | | | | | | | | | |
| 移模力 (鎖模) | Mould Close Force | kN | 29.1 | | | | | | | | | |
| 移模力 (開模) | Mould Open Traverse Force | kN | 27 | | | | | | | | | |
| 最大鎖模行程 | Max. Mould Open Stroke | mm | 425 | | | | | | | | | |
| 最小容模厚度 | Min. Mould Height | mm | 200 | | | | | | | | | |
| 最大容模厚度 | Max. Mould Height | mm | N/A | | | | | | | | | |
| 模板最大開距 | Max. Daylight | mm | 625 | | | | | | | | | |
| 四柱內距 (水平 x 垂直) | Space Between Tie-bars (HxV) | mm | 370 x 370 | | | | | | | | | |
| 模板尺寸 | Platen Size (HxV) | mm | 570 x 570 | | | | | | | | | |
| 哥林柱直徑 | Diameter of Tie-bars | mm | 50 | | | | | | | | | |
| 頂針力 | Ejector Force, Forward/Retract | kN | 34.6/23/7 | | | | | | | | | |
| 最大頂針行程 | Max. Ejector Stroke | mm | 150 | | | | | | | | | |
| 最大移模速度, 開模 / 鎖模 | Max. Velocity (Open/Close) | mm/sec | 760/707 | | | | | | | | | |
| 最大模具重量 | Max. Mould Weight - Total/Moving platen | kg | 580/380 | | | | | | | | | |
| 射台型號 | Injection Unit | | ST180 | | | ST245 | | | ST330 | | | |
| 螺桿直徑 | Screw Diameter | mm | 25 | 28 | 32 | 28 | 32 | 36 | 32 | 36 | 40 | |
| 理論注射容積 | Swept Volume | c.c | 61 | 77 | 101 | 86 | 112 | 142 | 128 | 162 | 201 | |
| 注射重量 (PS) | Shot Weight (PS) | g | 55 | 70 | 91 | 78 | 102 | 129 | 117 | 148 | 182 | |
| 注射壓力 | Specific Injection Pressure | bar | 3087 | 2460 | 1884 | 2952 | 2260 | 1785 | 2670 | 2109 | 1708 | |
| 高注射率 | Injection Rate | c.c/sec | 83 | 104 | 136 | 86 | 113 | 143 | 96 | 121 | 150 | |
| 注射速度 | Injection Velocity | mm/sec | 169 | | | 141 | | | 119 | | | |
| 塑化能力 (PS) | Plasticizing Capacity (PS) | g/sec | 12.2 | 16 | 23.3 | 12.4 | 18 | 25.6 | 12.9 | 18.3 | 23.8 | |
| 螺桿長徑比 | Screw L:D Ratio | L/D | 22.4 | 20 | 17.8 | 22.8 | 20 | 17.7 | 22.5 | 20 | 18 | |
| 注射行程 | Screw Stroke | mm | 125 | | | 140 | | | 160 | | | |
| 螺桿轉距 | Screw Torque | Nm | 403 | | | 503 | | | 727 | | | |
| 螺桿轉速 | Screw Speed | r.p.m. | 10-522 | | | 10-418 | | | 10-278 | | | |
| 射咀接觸力 | Nozzle Sealing Force | kN | 37.6 | | | 37.6 | | | 42.84 | | | |
| 射咀行程 | Nozzle Retract Stroke | mm | 220 | | | 220 | | | 220 | | | |
| 電熱功率 | Heating Capacity of Barrel | kW | 4.5 | | | 5.5 | | | 6.55 | | | |
| 加熱區的數量 | Number of Heating Zones & Barrel | qty | 4 + N | | | 4 + N | | | 4 + N | | | |
| 油泵電機功率 | Rated Power of Pump Drive Servo Motor | kW | | | | 14 | | | | | | |
| 油箱容積 | Oil Filling | l | | | | 220 | | | | | | |
| 液壓系統壓力 | Hydraulic System Pressure | bar | | | | 175 | | | | | | |
| 機器重量 | Machine Weight, Dry | Tons | 2.4 | | | 2.4 | | | 2.9 | | | |
| 外形尺寸 (LxWxH) | Machine Dimensions (LxWxH) | m | 3.3x1.36x1.94 | | | 3.6x1.36x1.94 | | | 3.7x1.36x1.94 | | | |
| 幹循環時間 | Dry Cycle Time (EUROMAP 6) | mm-sec | | | | 298-1.5 | | | | | | |
| 國際尺寸評級 | International Size Rating (EUROMAP) | ref | 500H-189 | | | 500H-254 | | | 500H-343 | | | |

3

• 最小模具尺寸 (mm) 為 230x230 / Smallest tolerable mould dimension: 230x230 (mm)
• 本公司可以隨時修改以上技術參數而無須預先通知 / The above specifications can be altered without prior notice

模板尺寸
Platen Dimension

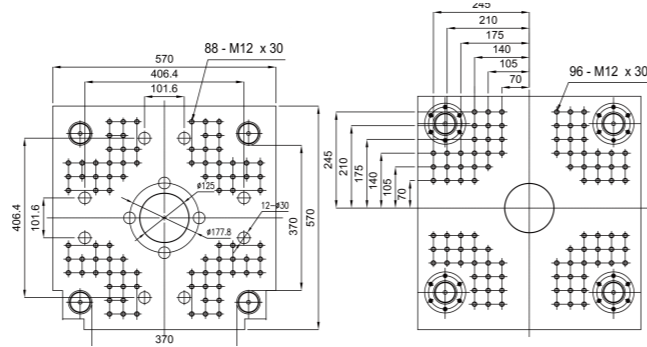

落料口尺寸
Feeding Hole Dimension

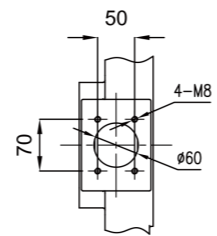

機械手安裝孔尺寸
Extractor Assembling Hole Dimension

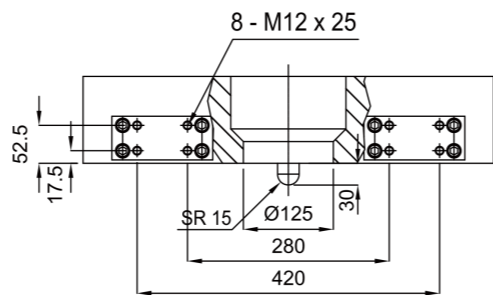

I-MACH 80

Machine Specification 機器參數

| 項目 | Items | Unit | I-MACH 80 | | | | | | | | | |
|-----------------|---|---------|----------------|------|------|---------------|------|------|----------------|------|-------|--|
| | | | ST225 | | | ST330 | | | ST470 | | | |
| 鎖模力 | Mould Locking Force | kN | 800 | | | | | | | | | |
| 開模力 (高壓) | Mould Unlocking Force | kN | 69.3 | | | | | | | | | |
| 移模力 (鎖模) | Mould Close Force | kN | 37.4 | | | | | | | | | |
| 移模力 (開模) | Mould Open Traverse Force | kN | 31.8 | | | | | | | | | |
| 最大鎖模行程 | Max. Mould Open Stroke | mm | 525 | | | | | | | | | |
| 最小容模厚度 | Min. Mould Height | mm | 250 | | | | | | | | | |
| 最大容模厚度 | Max. Mould Height | mm | N/A | | | | | | | | | |
| 模板最大開距 | Max. Daylight | mm | 775 | | | | | | | | | |
| 四柱內距 (水平 x 垂直) | Space Between Tie-bars (HxV) | mm | 420 x 420 | | | | | | | | | |
| 模板尺寸 | Platen Size (HxV) | mm | 665 x 665 | | | | | | | | | |
| 哥林柱直徑 | Diameter of Tie-bars | mm | 65 | | | | | | | | | |
| 頂針力 | Ejector Force, Forward/Retract | kN | 34.6/23.7 | | | | | | | | | |
| 最大頂針行程 | Max. Ejector Stroke | mm | 150 | | | | | | | | | |
| 最大移模速度, 開模 / 鎖模 | Max. Velocity (Open/Close) | mm/sec | 690/811 | | | | | | | | | |
| 最大模具重量 | Max. Mould Weight - Total/Moving platen | kg | 700/450 | | | | | | | | | |
| 射台型號 | Injection Unit | | ST225 | | | ST330 | | | ST470 | | | |
| 螺桿直徑 | Screw Diameter | mm | 28 | 32 | 36 | 32 | 36 | 40 | 36 | 40 | 45 | |
| 理論注射容積 | Swept Volume | c.c | 86 | 112 | 142 | 128 | 162 | 201 | 183 | 226 | 286 | |
| 注射重量 (PS) | Shot Weight (PS) | g | 78 | 102 | 129 | 117 | 148 | 182 | 166 | 205 | 260 | |
| 注射壓力 | Specific Injection Pressure | bar | 2952 | 2260 | 1785 | 2670 | 2109 | 1708 | 2646 | 2143 | 1693 | |
| 高注射率 | Injection Rate | c.c/sec | 86 | 113 | 143 | 96 | 121 | 150 | 88 | 119 | 151 | |
| 注射速度 | Injection Velocity | mm/sec | 141 | | | 119 | | | 95 | | | |
| 塑化能力 (PS) | Plasticizing Capacity (PS) | g/sec | 12.4 | 18 | 25.6 | 12.9 | 18.3 | 23.8 | 13.9 | 18.1 | 24.9 | |
| 螺桿長徑比 | Screw L:D Ratio | L/D | 22.8 | 20 | 17.7 | 22.5 | 20 | 18 | 22.22 | 20 | 17.77 | |
| 注射行程 | Screw Stroke | mm | 140 | | | 160 | | | 180 | | | |
| 螺桿轉距 | Screw Torque | Nm | 503 | | | 727 | | | 956 | | | |
| 螺桿轉速 | Screw Speed | r.p.m. | 10-418 | | | 10-278 | | | 10-209 | | | |
| 射咀接觸力 | Nozzle Sealing Force | kN | 37.71 | | | 43.1 | | | 43.1 | | | |
| 射咀行程 | Nozzle Retract Stroke | mm | 220 | | | 250 | | | 250 | | | |
| 電熱功率 | Heating Capacity of Barrel | kW | 5.5 | | | 6.55 | | | 8.25 | | | |
| 加熱區的數量 | Number of Heating Zones & Barrel | qty | 4 + N | | | 4 + N | | | 4 + N | | | |
| 油泵電機功率 | Rated Power of Pump Drive Servo Motor | kW | | | | 14 | | | | | | |
| 油箱容積 | Oil Filling | l | | | | 220 | | | | | | |
| 液壓系統壓力 | Hydraulic System Pressure | bar | | | | 175 | | | | | | |
| 機器重量 | Machine Weight, Dry | Tons | 3.4 | | | 3.7 | | | 3.8 | | | |
| 外形尺寸 (LxWxH) | Machine Dimensions (LxWxH) | m | 3.75x1.47x1.99 | | | 3.9x1.47x1.99 | | | 4.15x1.47x1.99 | | | |
| 幹循環時間 | Dry Cycle Time (EUROMAP 6) | mm-sec | | | | 367-1.7 | | | | | | |
| 國際尺寸評級 | International Size Rating (EUROMAP) | ref | 800H-254 | | | 800H-343 | | | 800H-486 | | | |

• 最小模具尺寸 (mm) 為 285x285 / Smallest tolerable mould dimension: 285x285 (mm)
• 本公司可以隨時修改以上技術參數而無須預先通知 / The above specifications can be altered without prior notice

模板尺寸
Platen Dimension

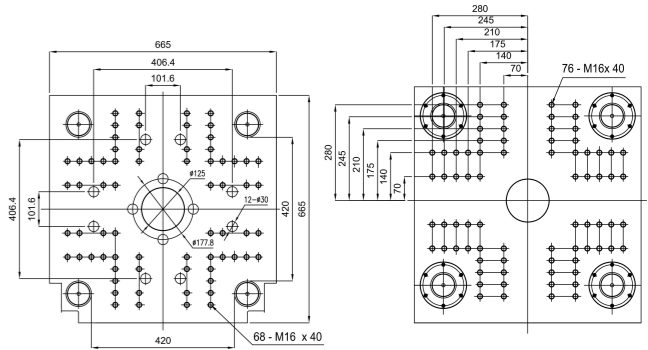

落料口尺寸
Feeding Hole Dimension

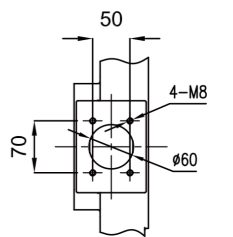

機械手安裝孔尺寸
Extractor Assembling Hole Dimension

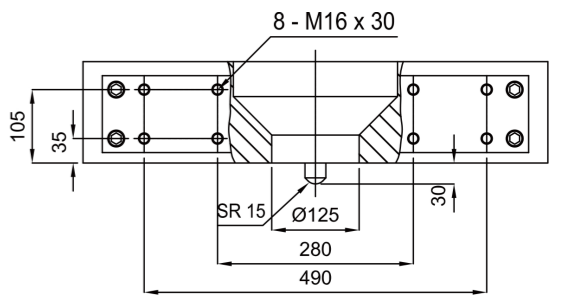

4

I-MACH 110

Machine Specification 機器參數

| 項目 | Items | Unit | I-MACH 110 | | | | | | | | | |
|-----------------|---|---------|----------------|------|------|---------------|------|-------|----------------|------|------|--|
| | | | ST330 | | | ST470 | | | ST640 | | | |
| 鎖模力 | Mould Locking Force | kN | 1100 | | | | | | | | | |
| 開模力 (高壓) | Mould Unlocking Force | kN | 83.8 | | | | | | | | | |
| 移模力 (鎖模) | Mould Close Force | kN | 42.9 | | | | | | | | | |
| 移模力 (開模) | Mould Open Traverse Force | kN | 40.9 | | | | | | | | | |
| 最大鎖模行程 | Max. Mould Open Stroke | mm | 625 | | | | | | | | | |
| 最小容模厚度 | Min. Mould Height | mm | 250 | | | | | | | | | |
| 最大容模厚度 | Max. Mould Height | mm | N/A | | | | | | | | | |
| 模板最大開距 | Max. Daylight | mm | 875 | | | | | | | | | |
| 四柱內距 (水平 x 垂直) | Space Between Tie-bars (HxV) | mm | 470 x 470 | | | | | | | | | |
| 模板尺寸 | Platen Size (HxV) | mm | 720 x 720 | | | | | | | | | |
| 哥林柱直徑 | Diameter of Tie-bars | mm | 75 | | | | | | | | | |
| 頂針力 | Ejector Force, Forward/Retract | kN | 34.6/23.7 | | | | | | | | | |
| 最大頂針行程 | Max. Ejector Stroke | mm | 150 | | | | | | | | | |
| 最大移模速度, 開模 / 鎖模 | Max. Velocity (Open/Close) | mm/sec | 781/752 | | | | | | | | | |
| 最大模具重量 | Max. Mould Weight - Total/Moving platen | kg | 1100/730 | | | | | | | | | |
| 射台型號 | Injection Unit | | ST330 | | | ST470 | | | ST640 | | | |
| 螺桿直徑 | Screw Diameter | mm | 32 | 36 | 40 | 36 | 40 | 45 | 40 | 45 | 50 | |
| 理論注射容積 | Swept Volume | c.c | 128 | 162 | 201 | 183 | 226 | 286 | 251 | 318 | 392 | |
| 注射重量 (PS) | Shot Weight (PS) | g | 117 | 148 | 182 | 166 | 205 | 260 | 228 | 289 | 357 | |
| 注射壓力 | Specific Injection Pressure | bar | 2670 | 2109 | 1708 | 2646 | 2143 | 1693 | 2627 | 2076 | 1681 | |
| 高注射率 | Injection Rate | c.c/sec | 120 | 152 | 187 | 121 | 149 | 189 | 122 | 154 | 190 | |
| 注射速度 | Injection Velocity | mm/sec | 160 | | | 119 | | | 97 | | | |
| 塑化能力 (PS) | Plasticizing Capacity (PS) | g/sec | 16.1 | 22.9 | 29.9 | 17.4 | 22.7 | 31.2 | 19.1 | 26.3 | 33.5 | |
| 螺桿長徑比 | Screw L:D Ratio | L/D | 22.5 | 20 | 18 | 22.22 | 20 | 17.77 | 22.5 | 20 | 18 | |
| 注射行程 | Screw Stroke | mm | 160 | | | 180 | | | 200 | | | |
| 螺桿轉距 | Screw Torque | Nm | 727 | | | 956 | | | 1137 | | | |
| 螺桿轉速 | Screw Speed | r.p.m. | 10-348 | | | 10-261 | | | 10-232 | | | |
| 射咀接觸力 | Nozzle Sealing Force | kN | 43.1 | | | 43.1 | | | 57.42 | | | |
| 射咀行程 | Nozzle Retract Stroke | mm | 250 | | | 250 | | | 320 | | | |
| 電熱功率 | Heating Capacity of Barrel | kW | 6.55 | | | 8.25 | | | 10.4 | | | |
| 加熱區的數量 | Number of Heating Zones & Barrel | qty | 4 + N | | | 4 + N | | | 4 + N | | | |
| 油泵電機功率 | Rated Power of Pump Drive Servo Motor | kW | 18 | | | | | | | | | |
| 油箱容積 | Oil Filling | l | 275 | | | | | | | | | |
| 液壓系統壓力 | Hydraulic System Pressure | bar | 175 | | | | | | | | | |
| 機器重量 | Machine Weight, Dry | Tons | 4.7 | | | 4.8 | | | 4.9 | | | |
| 外形尺寸 (LxWxH) | Machine Dimensions (LxWxH) | m | 3.95x1.61x1.92 | | | 4.1x1.61x1.92 | | | 4.35x1.61x1.92 | | | |
| 幹循環時間 | Dry Cycle Time (EUROMAP 6) | mm-sec | 438-2.0 | | | | | | | | | |
| 國際尺寸評級 | International Size Rating (EUROMAP) | ref | 1100H-343 | | | 1100H-486 | | | 1100H-486 | | | |

模板尺寸
Platen Dimension

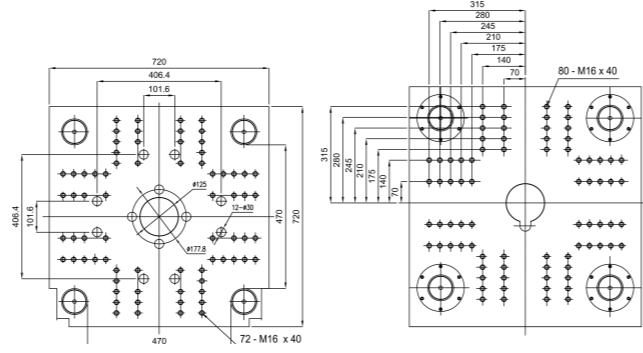

落料口尺寸
Feeding Hole Dimension

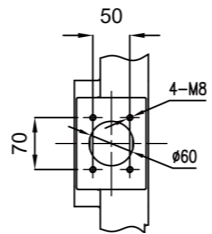

機械手安裝孔尺寸
Extractor Assembling Hole Dimension

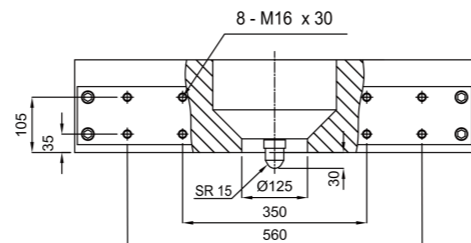

I-MACH 150

Machine Specification 機器參數

| 項目 | Items | Unit | I-MACH 150 | | | | | | | | | |
|-----------------|---|---------|----------------|------|-------|---------------|------|------|----------------|------|-------|--|
| | | | ST470 | | | ST640 | | | ST920 | | | |
| 鎖模力 | Mould Locking Force | kN | 1500 | | | | | | | | | |
| 開模力 (高壓) | Mould Unlocking Force | kN | 99.8 | | | | | | | | | |
| 移模力 (鎖模) | Mould Close Force | kN | 48.5 | | | | | | | | | |
| 移模力 (開模) | Mould Open Traverse Force | kN | 51.3 | | | | | | | | | |
| 最大鎖模行程 | Max. Mould Open Stroke | mm | 675 | | | | | | | | | |
| 最小容模厚度 | Min. Mould Height | mm | 300 | | | | | | | | | |
| 最大容模厚度 | Max. Mould Height | mm | N/A | | | | | | | | | |
| 模板最大開距 | Max. Daylight | mm | 975 | | | | | | | | | |
| 四柱內距 (水平 x 垂直) | Space Between Tie-bars (HxV) | mm | 500 x 500 | | | | | | | | | |
| 模板尺寸 | Platen Size (HxV) | mm | 780 x 780 | | | | | | | | | |
| 哥林柱直徑 | Diameter of Tie-bars | mm | 85 | | | | | | | | | |
| 頂針力 | Ejector Force, Forward/Retract | kN | 88.7/45.2 | | | | | | | | | |
| 最大頂針行程 | Max. Ejector Stroke | mm | 200 | | | | | | | | | |
| 最大移模速度, 開模 / 鎖模 | Max. Velocity (Open/Close) | mm/sec | 794/839 | | | | | | | | | |
| 最大模具重量 | Max. Mould Weight - Total/Moving platen | kg | 1700/1150 | | | | | | | | | |
| 射台型號 | Injection Unit | | ST470 | | | ST640 | | | ST920 | | | |
| 螺桿直徑 | Screw Diameter | mm | 36 | 40 | 45 | 40 | 45 | 50 | 45 | 50 | 55 | |
| 理論注射容積 | Swept Volume | c.c | 183 | 226 | 286 | 251 | 318 | 392 | 357 | 441 | 534 | |
| 注射重量 (PS) | Shot Weight (PS) | g | 166 | 205 | 260 | 228 | 289 | 357 | 325 | 402 | 486 | |
| 注射壓力 | Specific Injection Pressure | bar | 2646 | 2143 | 1693 | 2627 | 2076 | 1681 | 2646 | 2143 | 1771 | |
| 高注射率 | Injection Rate | c.c/sec | 152 | 188 | 238 | 153 | 194 | 240 | 152 | 188 | 228 | |
| 注射速度 | Injection Velocity | mm/sec | 150 | | | 122 | | | 96 | | | |
| 塑化能力 (PS) | Plasticizing Capacity (PS) | g/sec | 22.7 | 29.5 | 40.6 | 24.8 | 34.1 | 43.5 | 25.9 | 33 | 43 | |
| 螺桿長徑比 | Screw L:D Ratio | L/D | 22.22 | 20 | 17.77 | 22.5 | 20 | 18 | 22.33 | 20 | 18.18 | |
| 注射行程 | Screw Stroke | mm | 180 | | | 200 | | | 225 | | | |
| 螺桿轉距 | Screw Torque | Nm | 956 | | | 1137 | | | 1495 | | | |
| 螺桿轉速 | Screw Speed | r.p.m. | 10-329 | | | 10-292 | | | 10-219 | | | |
| 射咀接觸力 | Nozzle Sealing Force | kN | 43.1 | | | 57.24 | | | 56.7 | | | |
| 射咀行程 | Nozzle Retract Stroke | mm | 250 | | | 320 | | | 320 | | | |
| 電熱功率 | Heating Capacity of Barrel | kW | 8.25 | | | 10.4 | | | 13 | | | |
| 加熱區的數量 | Number of Heating Zones & Barrel | qty | 4 + N | | | 4 + N | | | 4 + N | | | |
| 油泵電機功率 | Rated Power of Pump Drive Servo Motor | kW | 23 | | | | | | | | | |
| 油箱容積 | Oil Filling | l | 350 | | | | | | | | | |
| 液壓系統壓力 | Hydraulic System Pressure | bar | 175 | | | | | | | | | |
| 機器重量 | Machine Weight, Dry | Tons | 6.8 | | | 6.9 | | | 7.0 | | | |
| 外形尺寸 (LxWxH) | Machine Dimensions (LxWxH) | m | 4.55x1.59x2.14 | | | 4.8x1.59x2.14 | | | 5.04x1.59x2.14 | | | |
| 幹循環時間 | Dry Cycle Time (EUROMAP 6) | mm-sec | 473-2.2 | | | | | | | | | |
| 國際尺寸評級 | International Size Rating (EUROMAP) | ref | 1500H-486 | | | 1500H-660 | | | 1500H-947 | | | |

模板尺寸
Platen Dimension

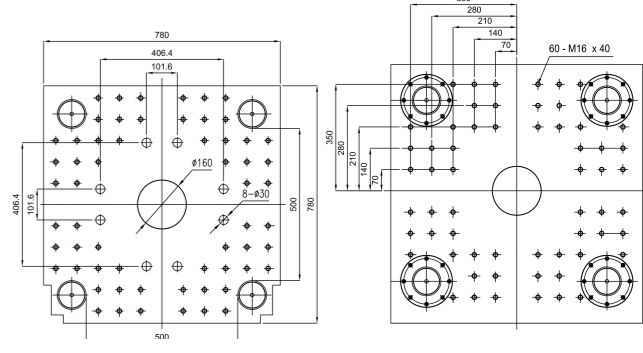

落料口尺寸
Feeding Hole Dimension

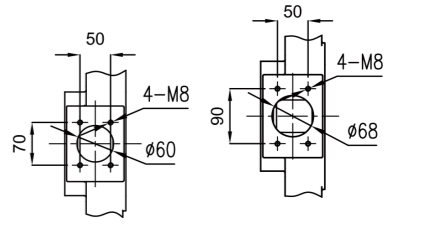

機械手安裝孔尺寸
Extractor Assembling Hole Dimension

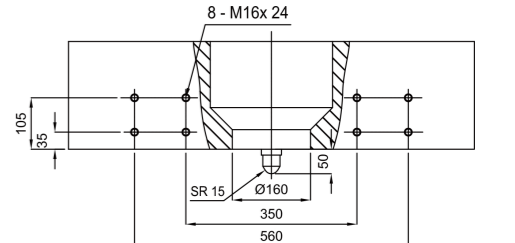

I-MACH 180

| 項目 | Items | Unit | I-MACH 180 | | |
|-----------------|---|---------|--|----------------|----------------|
| | | | ST640 | ST920 | ST1200 |
| 鎖模力 | Mould Locking Force | kN | 1800 | | |
| 開模力 (高壓) | Mould Unlocking Force | kN | 117.1 | | |
| 移模力 (鎖模) | Mould Close Force | kN | 54 | | |
| 移模力 (開模) | Mould Open Traverse Force | kN | 63 | | |
| 最大鎖模行程 | Max. Mould Open Stroke | mm | 725 | | |
| 最小容模厚度 | Min. Mould Height | mm | 300 | | |
| 最大容模厚度 | Max. Mould Height | mm | N/A | | |
| 模板最大開距 | Max. Daylight | mm | 1025 | | |
| 四柱內距 (水平 x 垂直) | Space Between Tie-bars (HxV) | mm | 560 x 560 | | |
| 模板尺寸 | Platen Size (HxV) | mm | 850 x 850 | | |
| 哥林柱直徑 | Diameter of Tie-bars | mm | 95 | | |
| 頂針力 | Ejector Force, Forward/Retract | kN | 88.7/45.2 | | |
| 最大頂針行程 | Max. Ejector Stroke | mm | 200 | | |
| 最大移模速度, 開模 / 鎖模 | Max. Velocity (Open/Close) | mm/sec | 668/753 | | |
| 最大模具重量 | Max. Mould Weight - Total/Moving platen | kg | 2500/1700 | | |
| 射台型號 | Injection Unit | | ST640 | ST920 | ST1200 |
| 螺桿直徑 | Screw Diameter | mm | 40 45 50 | 45 50 55 | 50 55 60 |
| 理論注射容積 | Swept Volume | c.c | 251 318 392 | 357 441 534 | 490 593 706 |
| 注射重量 (PS) | Shot Weight (PS) | g | 228 289 357 | 325 402 486 | 446 540 643 |
| 注射壓力 | Specific Injection Pressure | bar | 2627 2076 1681 | 2646 2143 1771 | 2527 2088 1754 |
| 高注射率 | Injection Rate | c.c/sec | 153 194 240 | 152 188 228 | 159 193 230 |
| 注射速度 | Injection Velocity | mm/sec | 122 96 81 | | |
| 塑化能力 (PS) | Plasticizing Capacity (PS) | g/sec | 24.8 34.1 43.5 | 25.9 33 43 | 26 33.9 43.2 |
| 螺桿長徑比 | Screw L:D Ratio | L/D | 22.5 20 18 | 22.33 20 18.18 | 22 20 18.33 |
| 注射行程 | Screw Stroke | mm | 200 225 250 | | |
| 螺桿轉距 | Screw Torque | Nm | 1137 1495 1897 | | |
| 螺桿轉速 | Screw Speed | r.p.m. | 10-292 | 10-219 | 10-175 |
| 射咀接觸力 | Nozzle Sealing Force | kN | 57.24 57.24 79.71 | | |
| 射咀行程 | Nozzle Retract Stroke | mm | 320 320 320 | | |
| 電熱功率 | Heating Capacity of Barrel | kW | 10.4 13 15.6 | | |
| 加熱區的數量 | Number of Heating Zones & Barrel | qty | 4 + N 4 + N 4 + N | | |
| 油泵電機功率 | Rated Power of Pump Drive Servo Motor | kW | 23 | | |
| 油箱容積 | Oil Filling | l | 350 | | |
| 液壓系統壓力 | Hydraulic System Pressure | bar | 175 | | |
| 機器重量 | Machine Weight, Dry | Tons | 8.4 8.3 8.8 | | |
| 外形尺寸 (LxWxH) | Machine Dimensions (LxWxH) | m | 4.92x1.75x2.19 5.16x1.75x2.19 5.43x1.75x2.19 | | |
| 幹循環時間 | Dry Cycle Time (EUROMAP 6) | mm-sec | 508-2.4 | | |
| 國際尺寸評級 | International Size Rating (EUROMAP) | ref | 1800H-660 1800H-947 1800H-1240 | | |

• 最小模具尺寸 (mm) 為 390x390 / Smallest tolerable mould dimension: 390x390 (mm)
 • 本公司可以隨時修改以上技術參數而無須預先通知 / The above specifications can be altered without prior notice

Machine Specification 機器參數

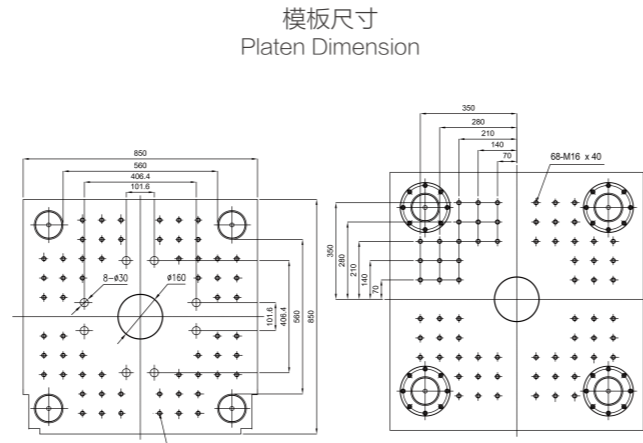

落料口尺寸
Feeding Hole Dimension

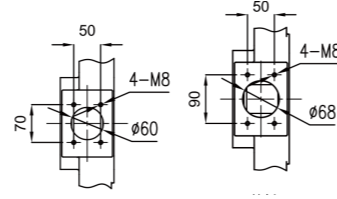

機械手安裝孔尺寸
Extractor Assembling Hole Dimension

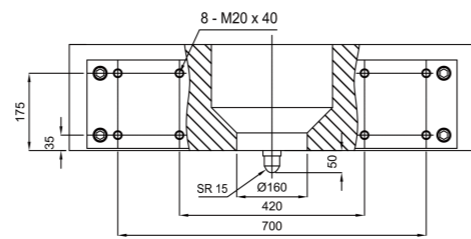

I-MACH 230

| 項目 | Items | Unit | I-MACH 230 | | |
|-----------------|---|---------|---|----------------|----------------|
| | | | ST920 | ST1200 | ST1540 |
| 鎖模力 | Mould Locking Force | kN | 2300 | | |
| 開模力 (高壓) | Mould Unlocking Force | kN | 135.8 | | |
| 移模力 (鎖模) | Mould Close Force | kN | 56.8 | | |
| 移模力 (開模) | Mould Open Traverse Force | kN | 79 | | |
| 最大鎖模行程 | Max. Mould Open Stroke | mm | 825 | | |
| 最小容模厚度 | Min. Mould Height | mm | 300 | | |
| 最大容模厚度 | Max. Mould Height | mm | N/A | | |
| 模板最大開距 | Max. Daylight | mm | 1125 | | |
| 四柱內距 (水平 x 垂直) | Space Between Tie-bars (HxV) | mm | 600 x 600 | | |
| 模板尺寸 | Platen Size (HxV) | mm | 870 x 870 | | |
| 哥林柱直徑 | Diameter of Tie-bars | mm | 100 | | |
| 頂針力 | Ejector Force, Forward/Retract | kN | 88.7/45.2 | | |
| 最大頂針行程 | Max. Ejector Stroke | mm | 200 | | |
| 最大移模速度, 開模 / 鎖模 | Max. Velocity (Open/Close) | mm/sec | 655/910 | | |
| 最大模具重量 | Max. Mould Weight - Total/Moving platen | kg | 3300/2200 | | |
| 射台型號 | Injection Unit | | ST920 | ST1200 | ST1540 |
| 螺桿直徑 | Screw Diameter | mm | 45 50 55 | 50 55 60 | 55 60 65 |
| 理論注射容積 | Swept Volume | c.c | 357 441 534 | 490 593 706 | 653 777 912 |
| 注射重量 (PS) | Shot Weight (PS) | g | 325 402 486 | 446 540 643 | 594 707 830 |
| 注射壓力 | Specific Injection Pressure | bar | 2646 2143 1771 | 2527 2088 1754 | 2431 2042 1740 |
| 高注射率 | Injection Rate | c.c/sec | 193 238 283 | 203 245 292 | 211 251 294 |
| 注射速度 | Injection Velocity | mm/sec | 121 103 88 | | |
| 塑化能力 (PS) | Plasticizing Capacity (PS) | g/sec | 31.9 40.6 52.9 | 32.1 41.8 53.4 | 32.1 40.9 51.3 |
| 螺桿長徑比 | Screw L:D Ratio | L/D | 22.33 20 18.18 | 22 20 18.33 | 21.81 20 18.46 |
| 注射行程 | Screw Stroke | mm | 225 250 275 | | |
| 螺桿轉距 | Screw Torque | Nm | 1495 1897 2469 | | |
| 螺桿轉速 | Screw Speed | r.p.m. | 10-278 | 10-222 | 10-167 |
| 射咀接觸力 | Nozzle Sealing Force | kN | 57.24 80.81 79.71 | | |
| 射咀行程 | Nozzle Retract Stroke | mm | 380 450 450 | | |
| 電熱功率 | Heating Capacity of Barrel | kW | 13 15.6 18.7 | | |
| 加熱區的數量 | Number of Heating Zones & Barrel | qty | 4 + N 4 + N 4 + N | | |
| 油泵電機功率 | Rated Power of Pump Drive Servo Motor | kW | 31 | | |
| 油箱容積 | Oil Filling | l | 440 | | |
| 液壓系統壓力 | Hydraulic System Pressure | bar | 175 | | |
| 機器重量 | Machine Weight, Dry | Tons | 9.7 10.2 10.3 | | |
| 外形尺寸 (LxWxH) | Machine Dimensions (LxWxH) | m | 5.33x1.95x2.19 5.58x1.95x2.19 5.7x1.95x2.19 | | |
| 幹循環時間 | Dry Cycle Time (EUROMAP 6) | mm-sec | 577-2.6 | | |
| 國際尺寸評級 | International Size Rating (EUROMAP) | ref | 2300H-947 2300H-1240 2300H-1588 | | |

• 最小模具尺寸 (mm) 為 440x440 / Smallest tolerable mould dimension: 440x440 (mm)
 • 本公司可以隨時修改以上技術參數而無須預先通知 / The above specifications can be altered without prior notice

Machine Specification 機器參數

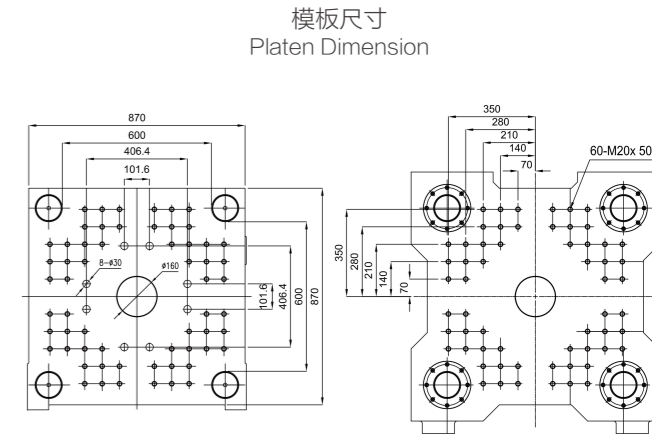

落料口尺寸
Feeding Hole Dimension

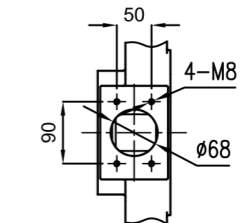

機械手安裝孔尺寸
Extractor Assembling Hole Dimension

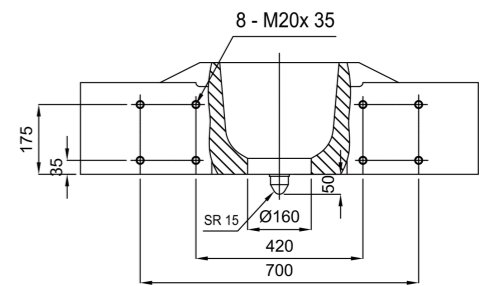

I-MACH 280

| 項目 | Items | Unit | I-MACH 280 | | | | | | | | | |
|---------------------|---|---------------------------------------|------------|---------------|------|-------|---------------|------|-------|----------------|------|------|
| CLAMPING UNIT 鎖模部份 | 鎖模力 | Mould Locking Force | kN | 2800 | | | | | | | | |
| | 開模力 (高壓) | Mould Unlocking Force | kN | 155.96 | | | | | | | | |
| | 移模力 (鎖模) | Mould Close Force | kN | 65.19 | | | | | | | | |
| | 移模力 (開模) | Mould Open Traverse Force | kN | 90.8 | | | | | | | | |
| | 最大鎖模行程 | Max. Mould Open Stroke | mm | 925 | | | | | | | | |
| | 最小容模厚度 | Min. Mould Height | mm | 300 | | | | | | | | |
| | 最大容模厚度 | Max. Mould Height | mm | N/A | | | | | | | | |
| | 模板最大開距 | Max. Daylight | mm | 1225 | | | | | | | | |
| | 四柱內距 (水平 x 垂直) | Space Between Tie-bars (HxV) | mm | 635 x 635 | | | | | | | | |
| | 模板尺寸 | Platen Size (HxV) | mm | 950 x 950 | | | | | | | | |
| | 哥林柱直徑 | Diameter of Tie-bars | mm | 115 | | | | | | | | |
| | 頂針力 | Ejector Force, Forward/Retract | kN | 88.7/45.2 | | | | | | | | |
| | 最大頂針行程 | Max. Ejector Stroke | mm | 200 | | | | | | | | |
| | 最大移模速度, 開模 / 鎖模 | Max. Velocity (Open/Close) | mm/sec | 712/993 | | | | | | | | |
| 最大模具重量 | Max. Mould Weight - Total/Moving platen | kg | 4000/3000 | | | | | | | | | |
| INJECTION UNIT 注射部份 | 射台型號 | Injection Unit | | ST1200 | | | ST1540 | | | ST1940 | | |
| | 螺桿直徑 | Screw Diameter | mm | 50 | 55 | 60 | 55 | 60 | 65 | 60 | 65 | 70 |
| | 理論注射容積 | Swept Volume | c.c | 490 | 593 | 706 | 653 | 777 | 912 | 848 | 995 | 1154 |
| | 注射重量 (PS) | Shot Weight (PS) | g | 446 | 540 | 643 | 594 | 707 | 830 | 771 | 905 | 1050 |
| | 注射壓力 | Specific Injection Pressure | bar | 2527 | 2088 | 1754 | 2431 | 2042 | 1740 | 2352 | 2004 | 1995 |
| | 高注射率 | Injection Rate | c.c/sec | 253 | 307 | 35 | 263 | 314 | 368 | 272 | 320 | 371 |
| | 注射速度 | Injection Velocity | mm/sec | 129 | | | 111 | | | 96 | | |
| | 塑化能力 (PS) | Plasticizing Capacity (PS) | g/sec | 40 | 52.2 | 66.5 | 40.1 | 51.1 | 64 | 45.4 | 56.9 | 65.9 |
| | 螺桿長徑比 | Screw L:D Ratio | L/D | 22 | 20 | 18.33 | 21.81 | 20 | 18.46 | 21.66 | 20 | 1857 |
| | 注射行程 | Screw Stroke | mm | 250 | | | 275 | | | 300 | | |
| | 螺桿轉距 | Screw Torque | Nm | 1897 | | | 2469 | | | 2778 | | |
| | 螺桿轉速 | Screw Speed | r.p.m. | 10-278 | | | 10-209 | | | 10-190 | | |
| | 射咀接觸力 | Nozzle Sealing Force | kN | 80.81 | | | 80.81 | | | 93.1 | | |
| | 射咀行程 | Nozzle Retract Stroke | mm | 450 | | | 450 | | | 480 | | |
| 電熱功率 | Heating Capacity of Barrel | kW | 15.6 | | | 18.7 | | | 21.5 | | | |
| 加熱區的數量 | Number of Heating Zones & Barrel | qty | 4 + N | | | 4 + N | | | 4 + N | | | |
| OTHERS 其他 | 油泵電機功率 | Rated Power of Pump Drive Servo Motor | kW | 39.4 | | | | | | | | |
| | 油箱容積 | Oil Filling | l | 550 | | | | | | | | |
| | 液壓系統壓力 | Hydraulic System Pressure | bar | 175 | | | | | | | | |
| | 機器重量 | Machine Weight, Dry | Tons | 11.4 | | | 11.5 | | | 11.7 | | |
| | 外形尺寸 (LxWxH) | Machine Dimensions (LxWxH) | m | 5.8x2.04x2.34 | | | 5.9x2.04x2.34 | | | 6.13x2.04x2.34 | | |
| | 幹循環時間 | Dry Cycle Time (EUROMAP 6) | mm-sec | 648-2.9 | | | | | | | | |
| | 國際尺寸評級 | International Size Rating (EUROMAP) | ref | 2800H-1240 | | | 2800H-1588 | | | 2800H-1995 | | |

• 最小模具尺寸 (mm) 為 450x450 / Smallest tolerable mould dimension: 450x450 (mm)
 • 本公司可以隨時修改以上技術參數而無須預先通知 / The above specifications can be altered without prior notice

Machine Specification 機器參數

模板尺寸
Platen Dimension

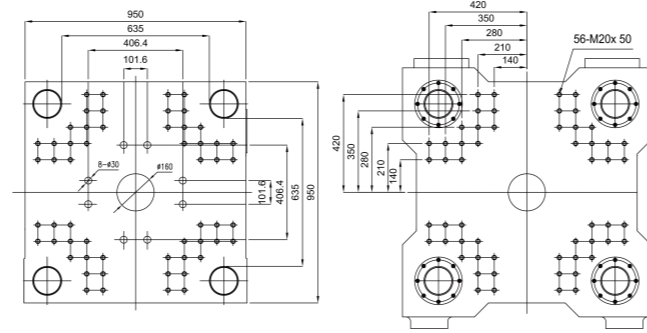

落料口尺寸
Feeding Hole Dimension

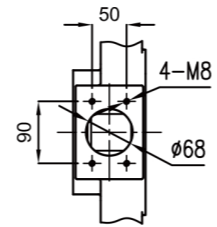

機械手安裝孔尺寸
Extractor Assembling Hole Dimension

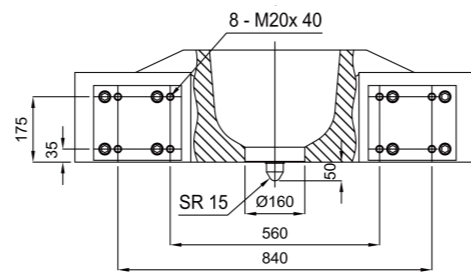

I-MACH 350

| 項目 | Items | Unit | I-MACH 350 | | | | | | | | | |
|---------------------|---|---------------------------------------|------------|---------------|------|-------|----------------|------|-------|----------------|------|------|
| CLAMPING UNIT 鎖模部份 | 鎖模力 | Mould Locking Force | kN | 3500 | | | | | | | | |
| | 開模力 (高壓) | Mould Unlocking Force | kN | 224.59 | | | | | | | | |
| | 移模力 (鎖模) | Mould Close Force | kN | 120.94 | | | | | | | | |
| | 移模力 (開模) | Mould Open Traverse Force | kN | 90.8 | | | | | | | | |
| | 最大鎖模行程 | Max. Mould Open Stroke | mm | 1025 | | | | | | | | |
| | 最小容模厚度 | Min. Mould Height | mm | 300 | | | | | | | | |
| | 最大容模厚度 | Max. Mould Height | mm | N/A | | | | | | | | |
| | 模板最大開距 | Max. Daylight | mm | 1375 | | | | | | | | |
| | 四柱內距 (水平 x 垂直) | Space Between Tie-bars (HxV) | mm | 710 x 710 | | | | | | | | |
| | 模板尺寸 | Platen Size (HxV) | mm | 1100 x 1100 | | | | | | | | |
| | 哥林柱直徑 | Diameter of Tie-bars | mm | 130 | | | | | | | | |
| | 頂針力 | Ejector Force, Forward/Retract | kN | 88.7/45.2 | | | | | | | | |
| | 最大頂針行程 | Max. Ejector Stroke | mm | 250 | | | | | | | | |
| | 最大移模速度, 開模 / 鎖模 | Max. Velocity (Open/Close) | mm/sec | 786/674 | | | | | | | | |
| 最大模具重量 | Max. Mould Weight - Total/Moving platen | kg | 5100/3400 | | | | | | | | | |
| INJECTION UNIT 注射部份 | 射台型號 | Injection Unit | | ST1540 | | | ST1940 | | | ST2500 | | |
| | 螺桿直徑 | Screw Diameter | mm | 55 | 60 | 65 | 60 | 65 | 70 | 65 | 70 | 75 |
| | 理論注射容積 | Swept Volume | c.c | 653 | 777 | 912 | 848 | 995 | 1154 | 1078 | 1250 | 1435 |
| | 注射重量 (PS) | Shot Weight (PS) | g | 594 | 707 | 830 | 771 | 905 | 1050 | 981 | 1138 | 1306 |
| | 注射壓力 | Specific Injection Pressure | bar | 2431 | 2042 | 1740 | 2352 | 2004 | 1728 | 2385 | 2057 | 1792 |
| | 高注射率 | Injection Rate | c.c/sec | 332 | 393 | 464 | 343 | 403 | 467 | 338 | 393 | 451 |
| | 注射速度 | Injection Velocity | mm/sec | 139 | | | 121 | | | 102 | | |
| | 塑化能力 (PS) | Plasticizing Capacity (PS) | g/sec | 50.2 | 64 | 80.2 | 56.8 | 71.1 | 82.5 | 58.1 | 67.4 | 82.2 |
| | 螺桿長徑比 | Screw L:D Ratio | L/D | 22.81 | 20 | 18.46 | 21.66 | 20 | 18.57 | 21.53 | 20 | 1866 |
| | 注射行程 | Screw Stroke | mm | 275 | | | 300 | | | 325 | | |
| | 螺桿轉距 | Screw Torque | Nm | 2469 | | | 2778 | | | 3990 | | |
| | 螺桿轉速 | Screw Speed | r.p.m. | 10-263 | | | 10-239 | | | 10-180 | | |
| | 射咀接觸力 | Nozzle Sealing Force | kN | 79.71 | | | 91.66 | | | 91.66 | | |
| | 射咀行程 | Nozzle Retract Stroke | mm | 450 | | | 450 | | | 450 | | |
| 電熱功率 | Heating Capacity of Barrel | kW | 18.7 | | | 21.5 | | | 23.10 | | | |
| 加熱區的數量 | Number of Heating Zones & Barrel | qty | 4+ N | | | 4 + N | | | 4 + N | | | |
| OTHERS 其他 | 油泵電機功率 | Rated Power of Pump Drive Servo Motor | kW | 45 | | | | | | | | |
| | 油箱容積 | Oil Filling | l | 700 | | | | | | | | |
| | 液壓系統壓力 | Hydraulic System Pressure | bar | 175 | | | | | | | | |
| | 機器重量 | Machine Weight, Dry | Tons | 14.4 | | | 14.6 | | | 14.9 | | |
| | 外形尺寸 (LxWxH) | Machine Dimensions (LxWxH) | m | 6.2x2.25x2.39 | | | 6.43x2.25x2.39 | | | 6.75x2.25x2.39 | | |
| | 幹循環時間 | Dry Cycle Time (EUROMAP 6) | mm-sec | 718-3.2 | | | | | | | | |
| | 國際尺寸評級 | International Size Rating (EUROMAP) | ref | 3500H-1588 | | | 3500H-1995 | | | 3500H-2572 | | |

• 最小模具尺寸 (mm) 為 600x600 / Smallest tolerable mould dimension: 600x600 (mm)
 • 本公司可以隨時修改以上技術參數而無須預先通知 / The above specifications can be altered without prior notice

Machine Specification 機器參數

模板尺寸
Platen Dimension

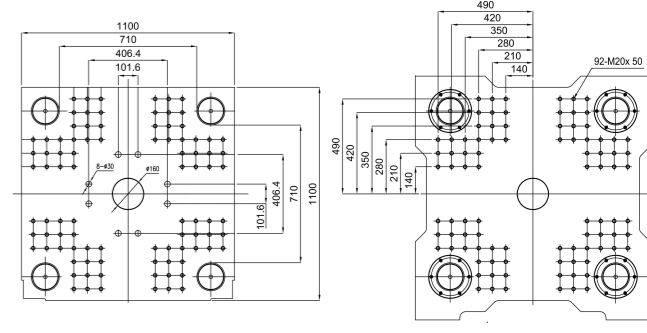

落料口尺寸
Feeding Hole Dimension

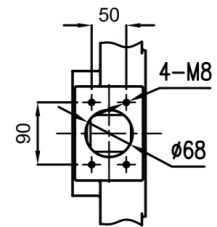

機械手安裝孔尺寸
Extractor Assembling Hole Dimension

